

aaainnovations THE NIGHTLIFE



Inflatable Solar & USB Powered Color LED Dual-BT Wireless Speaker

INSTRUCTION



Important Notes

Before using the product, it is critical for the user to fully charge the product with the provided Type-C cable for 2.5 hours. While charging, the green LED indicator flashes, and the four green LED indicators will light up when fully charged.

Recommended for solar charging in inflated state.

Special Notes:

To inflate and deflate the product, it is necessary to pinch the bottom of the valve to open the valve, so that it can be in or out of the air, then pull or press the item down evenly and slowly to make the product inflate or deflate. It is necessary to avoid the product from being pulled or pressed by brutality to cause product damage.

The lantern is not a toy. Keep it away from children.

The lantern contains a rechargeable Li-ion battery that cannot be replaced.

Product accessories

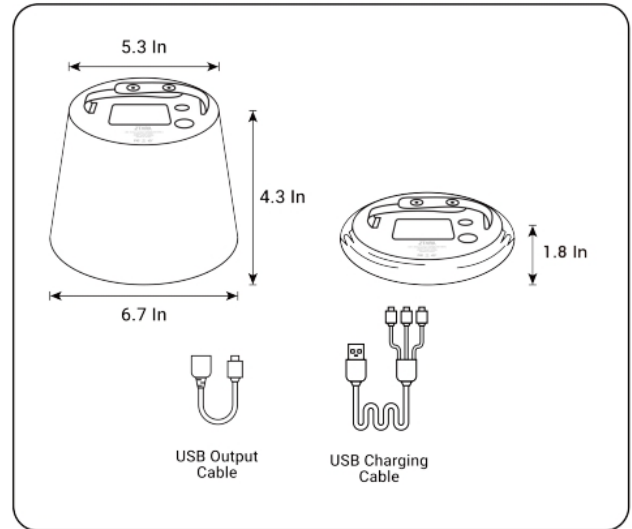

How to Charge

1. Charge the product directly with the Type-C cable provided. The charging time is about 2.5 hours
2. Solar charging: expose the solar panel to the sunlight for 40-48h to fully charge the product.

Notice: The charging port needs to be covered with the plug when not in use to avoid water.

Specification

Inflatable size	3.5*5.3*6.7*4.3inches
Material	TPU
Net weight (about)	0.66lb
Lighting	White Light+Warm Light+RGB Light
Battery capacity	4400 mAh
Solar panel	5V/100mA
Solar charging time	40-48 hours under direct and strong sunlight
Charging time	around 2.5 hours with Type-C cable

USB Output

The product comes with a USB output cable for using it as a power bank in emergency. Connect the USB output cable to the USB port beside the solar panel, and connect the other end of the USB output cable with your USB charging cable, then you can use it as a power bank



How to Connect Bluetooth

1. Long Press the Switch for 3 seconds to turn on Bluetooth, until hear "Bluetooth device is ready to pair"
2. Enable the Bluetooth function on your phone, search "eflatables" and connect, you will hear "Bluetooth device is connected successfully" from the item.
3. Play the music on your phone
4. To connect 2 LED lanterns: Turn on bluetooth pairing at the same time on both devices. LED lanterns will automatically connect to each other.
5. Long press the Switch Button for 3 seconds to turn off the Bluetooth, you will hear "Bluetooth Power Off"



Bottom Inflating nozzle



How to Use

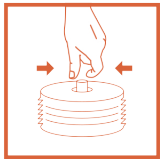

Pull out the valve and open the plug. Pinch the bottom of the valve and pull the item up and wait for a minute to fill it with air.

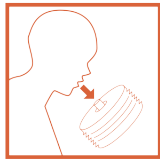

Then blow the air in to make it full of air; keep pinching the bottom of the valve when you are blowing.

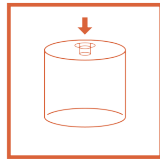

Insert the plug, push the valve in.

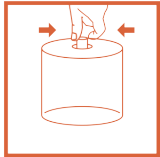

Open the plug and pinch the bottom of the valve.

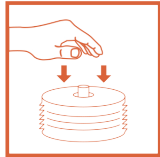

Push down the lantern to deflate.

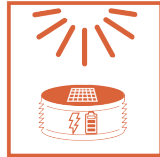

Put the item down the sun to use solar charge.

Note: When the dual Bluetooth mode is used for the first time, after long press music button to turn on the Bluetooth mode of the two lanterns, you need to double-click the music button of any one of the lanterns to make the Bluetooth of the two lanterns connect with each other. After that, when dual devices Bluetooth mode are turned on, the two lanterns will automatically pair to each other.

FAQ (Frequently-asked Question)

● What are the lighting modes?

There are 3 modes lighting.

1.White and Warm lights switch

Five gear light mode: 1st gear: 25% brightness/ 2nd gear: 50% brightness/ 3rd gear: 75% brightness 4th gear: 100% brightness / 5th gear: warm light

2.RGB lights switch

Switch respectively the following lights modes:

Red light + green light + blue light + purple light + seven-color changed breathing mode + seven-color slow flashing mode + SOS red light

3.The colorful lights flash changed with the playing music rhythm

● How long does it last?

The lamp can be used for a couple of hours, but the specific use time depends on the lighting modes:

1. Flash Mode: 28-30H/50LM

2. High bright Mode: 4H/267LM

3. Low bright Mode: 45H/31LM

4. Speaker Working Time: 10-100H

5. SOS Mode: 52/31LM

● Can this lantern be put into water?

The answer is yes. This product is IP66 waterproof, can be used in the rain and pool without worries

● Why is the blue light flashing?

The bluetooth works when the blue light is on, and please long press again to turn off the bluetooth.

● Does it have an indicator to let you know that it's fully charged?

The red indicator light will be showed during charging via solar or Type-C cable, the green light is on when fully charged

● How long does it take to fully charge the battery?

It takes about 2.5 hrs to fully charge with type-c cable while the solar needs 40 to 48 hrs under direct sunlight to fully charge.

● What is the distance to connect the bluetooth?

In 10 meters.

● Why does the lantern cannot be fully inflatable?

Please pinch the air valve until the lantern is 80% inflated, and then blow it to make it full of air.

● Why can't it lay flat?

Please insert the air valve into the lantern body after inflating it.